

SPECIAL EVENTS CENTER

SETTING FOR SUCCESS

The Fantasy Springs Special Events Center sets a new standard for group functions, conventions and concerts in the Palm Springs Valley. From private meetings to large scale exhibits and conventions, this facility is designed to host events that seat up to 3,700+ people, yet can be reconfigured to handle multiple smaller functions at the same time. Constructed by the Howard S. Wright Company, builders of the Space Needle in Seattle, Washington, the Special Events Center can accommodate just about any event. For large groups and conventions, concession stands are located on both sides of the main Exhibit Hall. Ballrooms and a Boardroom are available for smaller functions.

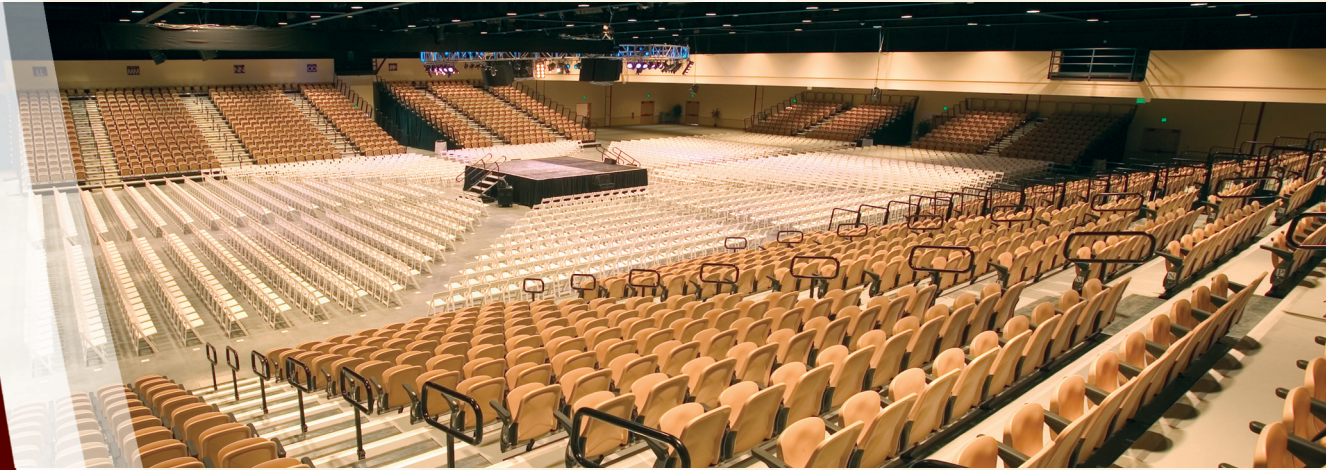

SPECIAL EVENTS CENTER

Special Events Center Meeting Rooms

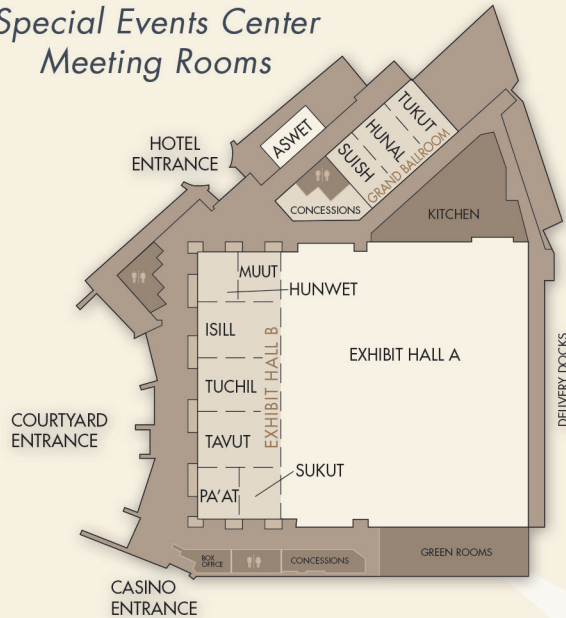

Cabazon Rooms

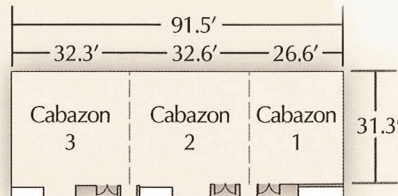

LIT

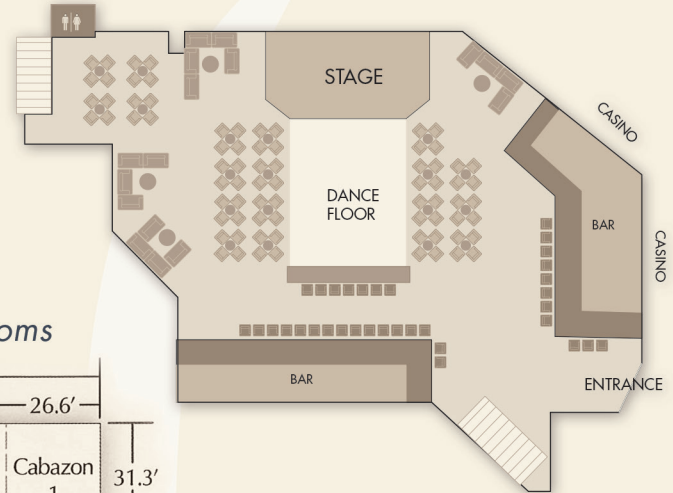

ROOM	SQUARE FEET	DIMENSIONS	CLASSROOM	U-SHAPE	THEATRE	BANQUET	RECEPTION	EXHIBITS	CEILING
Exhibit Hall	44,460	234x190	2176	n/a	4876	2800	5550	220/278	25'/17'
Hall A	33,060	190x170	1536	n/a	3496	1960	4130	165/206	25'
Hall B	11,400	190x60	528	n/a	1066	680	1425	57/71	17'
Hunwet	1,100	36x30	40	32	90	60	135	n/a	17'
Muut	1,100	36x30	40	32	90	60	135	n/a	17'
Isill	2,340	60x39	108	48	240	150	292	11/14	17'
Tuchil	2,340	60x39	108	48	240	150	292	11/14	17'
Tavut	2,340	60x39	108	48	240	150	292	n/a	17'
Pa'at	1,100	36x30	40	32	90	60	135	n/a	17'
Sukut	1,100	36x30	40	32	90	60	135	n/a	17'
Grand Ballroom	3,400	81x42	182	n/a	374	260	425	18/20	17'
Suish	1,050	42x25	48	29	100	60	131	n/a	17'
Hunal	1,300	42x31	60	32	120	80	163	n/a	17'
Tukut	1,050	42x25	48	29	100	60	131	n/a	17'
Aswet	670	35x20	n/a	n/a	n/a	Boardroom Style		n/a	15'
Octagon Room	1,440	20x72	n/a	n/a	n/a	n/a	150	n/a	15'
LIT Bar	2,880	40x72	n/a	n/a	n/a	n/a	250	n/a	35'
Grand Cabazon	2,944	92x32	150	n/a	300	170	285	17	16'
Cabazon Room 1	864	27x32	40	20	80	40	80	n/a	16'
Cabazon Room 2	1,024	32x32	55	25	100	60	100	n/a	16'
Cabazon Room 3	1,024	32x32	55	25	100	60	100	n/a	16'